

# SSR5

## Eco-friendly Non-hydraulic Machine with 3-axis NC



(This is the photo of the machine with optional equipments.)



- Environment-friendly non-hydraulic NC decreases thermal displacement.
- Enhanced feed axis speed shortens setup time and air cutting time.
- Linear guides provided for both vertical and horizontal axes improves straightness.
- Teaching function on both right and left side and manual pulse handle improve the usability.
- Automatic table dressing function that enhances dimensional accuracy is standard equipment.
- AMADA MACHINE TOOLS' original softwares (option) are installed.



## Machine Specification

Item		Unit	SSR-5			
Capacity	Diameter of solenoid chuck valve	mm	508			
	Distance between chuck upper surface and grinding wheel lower surface	mm	125			
	Maximum swing in table cover	mm	550			
Table	Effective diameter of electromagnetic chuck	mm	420			
	Rotation speed / Rotation speed range conversion number	min <sup>-1</sup> / step	50~300 / 21			
	Vertical travel distance	mm	190			
	Maximum angle of inclination	°	±3			
	Manual	Handle feed amount	Magnification Off, ×0.1 ×1, ×10 ×40	By a rotation	mm	0.01, 0.1, 1.0, 4.0
				By a scale	mm	0.0001, 0.001, 0.01, 0.04
	Jog feed		m / min	100, 500, 1000, 2000		
	Operation method		—	Jog lever pulse handle		
	Automatic	Feed speed	Fast feed	mm / min	2,000	
			Grinding feed	mm / min	0.1~1,000	
Minimum setting unit		mm	0.0001			
Ram	Travel distance	mm	335			
	Manual	Handle feed amount	Magnification Off, ×0.1 ×1, ×10 ×40	By a rotation	mm	0.01, 0.1, 1.0, 4.0 [OP]
				By a scale	mm	0.0001, 0.001, 0.01, 0.04 [OP]
	Jog feed		mm / min	0~800, 1,000, 2,000, 4,000		
	Operation method		—	Jog lever pulse handle [OP]		
	Automatic	Feed speed	Fast feed	mm / min	5,000	
			Grinding feed	mm / min	0.1~5,000	
	Minimum setting unit		mm	0.0001		
	Grinding wheel	Outside diameter × Width × Inside diameter	mm	355×38×127		
		Rotation speed	min <sup>-1</sup>	0~2,500		
Electric device	Grinding wheel axis	kW·P	7.5 / 11			
	For table rotation	kW	1.8			
	For vertical feed	kW	1.4			
	For ram actuation	kW	1.2			
	Automatic lubrication pump	W	25			
Electric capacity	kVA	17				
Dimensions / Weight	Dimensions (length × width × height)	mm	2,120 × 1,154 × 1,602			
	Required floor space (including dust collection and coolant equipments and maintenance spaces)	mm	2,800 × 2,095			
	Total weight of the machine	kg	2,650			

## Control Unit Specification

Control unit model	F-0IT (FANUC)
controlled axes	Single axis x 2, Table rotation axis x 1 (X-axis : cross feed Z-axis : vertical B-axis : table rotation)

### Standard Function

Automatic demagnetizing device · Electromagnetic / Permanent magnetic chuck supported · Simplified permanent chuck demagnetizing function  
 Stepless magnetic force adjustment knob · Electric leakage breaker (sensed current : 30mA)  
 7.2 inch monochrome CD / MDI unit · Dressing interval (in-grinding dressing)  
 Z-axis (vertical) manual handle · Manual reference point returning · Stored stroke limit  
 Table rotation override 0~100% · Ram actuation override 0~100%  
 Constant table rotation speed control · Grinding wheel speed S command · Self-diagnostic function  
 Alarm and alarm history display · Actual speed display · Clock display · Current position display  
 Servo adjustment image · Ram position teaching push button · Operation time / Number of parts display  
 Chuck workpiece / Workpiece reference push button · Relative coordinate origin push button  
 End message · Buzzer (volume adjustable) · Automatic table dressing function

### Optional Function

X-axis (ram) manual handle · Handle interruption · Interruption dressing · Running timer  
 Warning light (1 color [yellow]) · Warning light (3 colors [red · yellow · green]) · Operation time display  
 AC100V power outlet (2P) · Imperial units available

### Special Accessories

Chuck	Electromagnetic chuck table (ring pole P=8)
	Electromagnetic chuck table (star pole)
	Electromagnetic chuck table (star and ring pole)
Coolant equipment	Vacuum adsorption chuck device (not including adapter plate)
	Magnetic separator type dust collection and coolant device (150 liters) FW-152-GK
	Paper + magnetic separator type dust collection and coolant device (150 liters)
Dresser	Grinding fluid temperature control device
	Electric dresser
Spindle	Balancing arbor
	Optional grinding wheel flange
	Grinding wheel width 50mm
Others	Balance board
	Working lamp
	Specified color

### Control panel (including options)



## External View

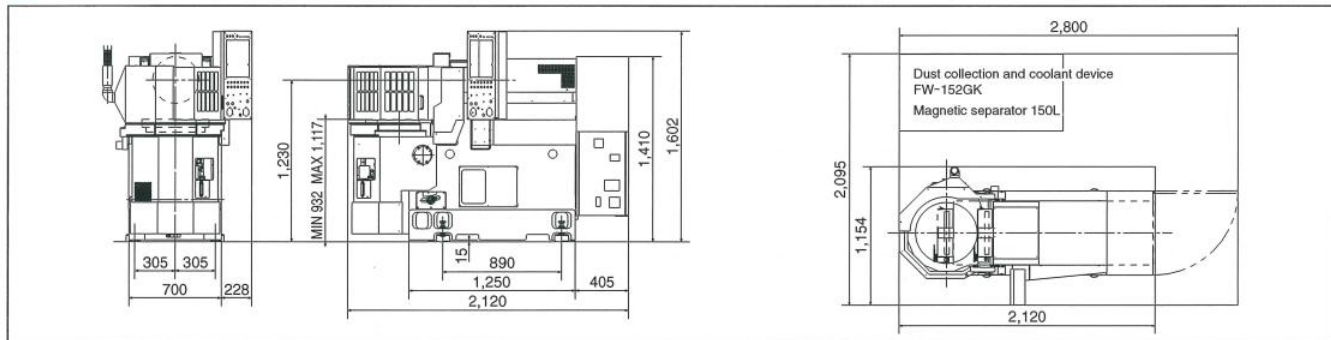

# AMADA MACHINE TOOLS CO., LTD.

www.amada.com

### [Head Quarters]

200, Ishida, Isehara-shi, Kanagawa, 259-1196, Japan

TEL : 81-463-96-3353

### [Overseas Group]

AMADA MACHINE TOOLS AMERICA INC.  
2324 Palmer Dr. Schaumburg, IL, 60173 U.S.A

TEL : 1-847-285-4800

### AMADA MACHINE TOOLS EUROPE GmbH

■ Head office  
AMADA Allee 3, 42781 Haan, Germany

TEL : 49-2104 -1777-0

■ France office  
Zone industrielle PARIS Nord II,  
96 Avenue de la Pyramide, 93290 Tremblay, France

TEL : 33-0149-903-094

■ Italy office  
Via Amada I, 1/3 29010 Pontenure, Piacenza, ITALY

TEL : 39-0523-872-311

### AMADA WASINO (THAILAND) CO., LTD.

700/146 Village No. 1, Bankao Sub-District,  
Panthong District, Chonburi 20160 Thailand

TEL : 66-3846-8920

### [Associates]

#### AMADA CO., LTD.

200, Ishida, Isehara-shi, Kanagawa, 259-1196, Japan

TEL : 81-463-96-1111

#### AMADA MACHINE TOOLS MFG CO., LTD.

2-158 Nakashima, Shimoobari, Komaki-shi, Aichi,  
485-0051, Japan

TEL : 81-568-71-8821

Specifications and design are subject to modify without notice.

1GW-04107-A001